



JLG Series Pure GEL battery JLG6-280

General Features

- ▶ Nanosilica colloidal electrolyte and high tin positive plate alloy design to enhance battery performance
- ▶ Relatively rich electrolyte, high temperature and low temperature performance is superior
- ▶ Long cycle life, excellent deep cycle discharge ability
- ▶ Excellent charge acceptance ability
- ▶ Precision sealing technology
- ▶ Long life



Dimension: 295(L) × 178(W) × 345(H) × 365(TH)

Unit: mm

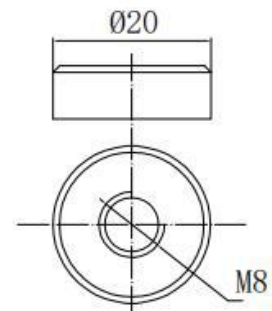
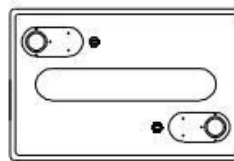
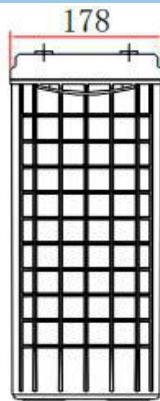
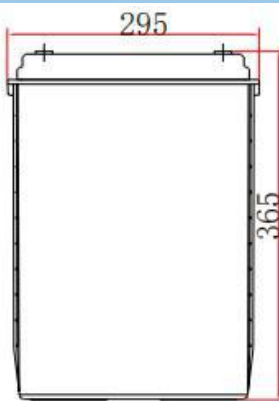

Terminal Dimensions

Specification	
Nominal Voltage	6V
Nominal Capacity	280Ah
Design life	10 years
Terminal	M8
Approx. Weight	Approx 45.0kg (99.2lbs)
Container Material	ABS
short-circuit current	2500A
Internal resistance(Full charged at 25°C:)	2.4 mΩ
Self discharge	3% of capacity declined per month at 25°C
Operating Temperature	
Discharge:	-40 ~60°C(-40~ 140°F)
Charge :	-20 ~50°C(-4~ 122°F)
Storage:	-20 ~50°C(-4~ 122°F)
Charge Method(25 °C)	
Charge current:	Max. 70.0A; Recom.28.0A
Float charge:6.75-6.90V	recom.6.90V(-9mV/ °C)
Equalize charge:6.90-7.05V	recom.7.05V(-12mV/ °C)
Cycle charge:7.20-7.50V	recom.7.35V(-15mV/ °C)

Applications

- ▶ UPS/EPS
- ▶ Power systems
- ▶ Telecommunications system
- ▶ Emergency lighting, Auto control system
- ▶ Solar / wind energy and other new energy storage
- ▶ Other general purpose

Rated Capacity

20Hour Rate (14.0A to 5.25V)	280.0Ah
3Hour Rate (71.2A to 5.10V)	213.6Ah
1Hour Rate (155A to 4.80V)	155.0Ah

Attain Certificate



Disclaimer: Manufacturers have the right to self-modify the parameters of the product updates, please keep in touch with manufacturers to obtain the latest information.

Discharge characteristic

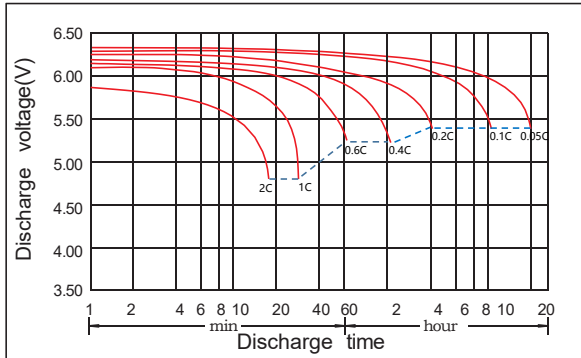

Charging characteristic

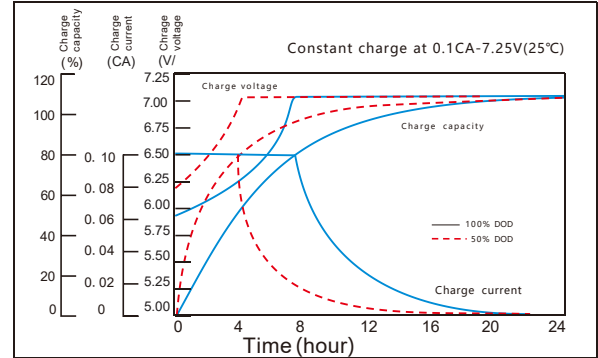

The effect of temperature on capacity

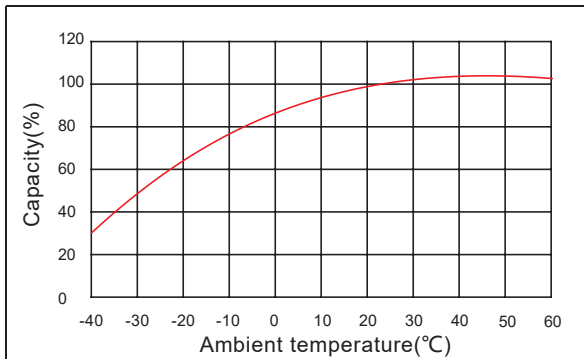

Curves of open circuit voltage vs. capacity

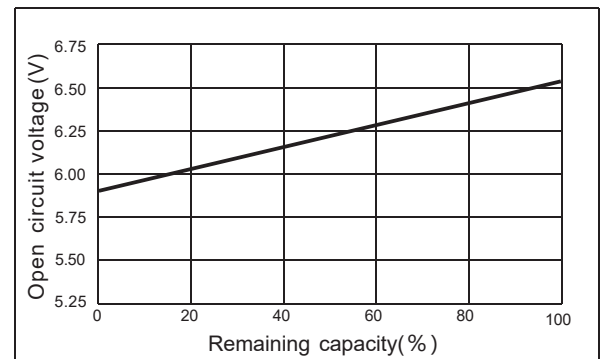

Constant Current Discharge Characteristics Unit:A (25°C,77°F)

FV/Time	30min	1h	2h	3h	5h	8h	10h	20h
1.60V	250	155	89.0	72.9	48.9	30.2	25.5	14.3
1.65V	245	154	88.5	72.3	48.6	29.9	25.2	14.2
1.70V	240	153	87.7	71.2	48.0	29.7	25.0	14.1
1.75V	239	151	86.5	70.3	47.4	29.5	24.7	14.0
1.80V	228	147	84.9	70.0	46.3	29.4	24.5	13.9
1.85V	208	136	80.6	66.0	44.0	28.0	23.8	13.7

Constant Power Discharge Characteristics Unit: W/cell (25°C,77°F)

FV/Time	30min	1h	2h	3h	5h	8h	10h	20h
1.60V	450	294	169	139	92.9	58.8	49.0	28.1
1.65V	448	292	168	137	92.3	58.3	48.5	28.0
1.70V	447	289	167	136	91.7	58.0	47.9	27.9
1.75V	445	287	166	135	91.1	57.9	47.6	27.7
1.80V	433	284	165	134	90.0	57.2	47.1	27.6
1.85V	397	263	158	128	85.9	55.3	46.3	27.3