

General Features

- ▶ High corrosion resistant performance: Pb-Ca multi-alloy grid
- ▶ High energy density and power density
- ▶ Optimized capability of instant high-current discharging
- ▶ Excellent charge acceptance ability
- ▶ Excellent deep cycle discharge capability
- ▶ Strong high and low temperature performance
- ▶ Precision sealing technology
- ▶ Long life



Dimension: 175(L) × 166(W) × 125(H) × 125(TH)

Unit: mm

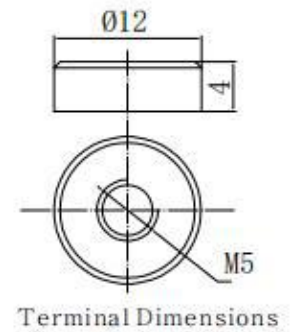
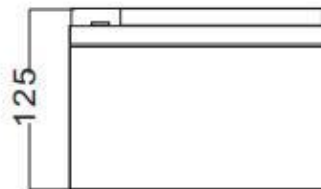
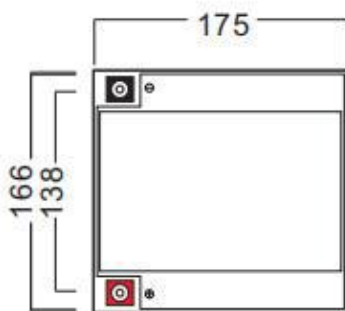

Specification	
Nominal Voltage	12V
Nominal Capacity	28Ah(102W@15min-rate to 1.67V percell@25°C)
Design life	5 years
Terminal	M5
Approx. Weight	Approx 8.55kg (18.8lbs)
Container Material	ABS(UL94-HB, UL94-V0 Optional)
short-circuit current	1142A
Internal resistance(Full charged at 25°C:)	10.5 mΩ
Self discharge	3% of capacity declined per month at 25°C
Operating Temperature	
Discharge:	-20 ~50°C(-4~ 122°F)
Charge :	-20 ~50°C(-4~ 122°F)
Storage:	-20 ~50°C(-4~ 122°F)
Charge Method(25 °C)	
Charge current:	Max. 7.0A;Recom.2.8A
Float charge:13.5-13.8V	recom.13.8V(-18mV/ °C)
Equalize charge:13.8-14.1V	recom.14.1V(-24mV/ °C)
Cycle charge:14.4-15.0V	recom.14.7V(-30mV/ °C)

Standards

Executive standard YD/T 3427-2018

Applications

- ▶ UPS/EPS
- ▶ Power systems
- ▶ Telecommunications system
- ▶ Emergency lighting, Auto control system
- ▶ Solar/wind generating storage cyclic
- ▶ Other general purpose

Rated Capacity

20Hour Rate (1.40A to 10.5V)	28.0Ah
3Hour Rate (7.36A to 10.2V)	22.1Ah
1Hour Rate (17.9A to 9.6V)	17.9Ah

Attain Certificate



Discharge characteristic

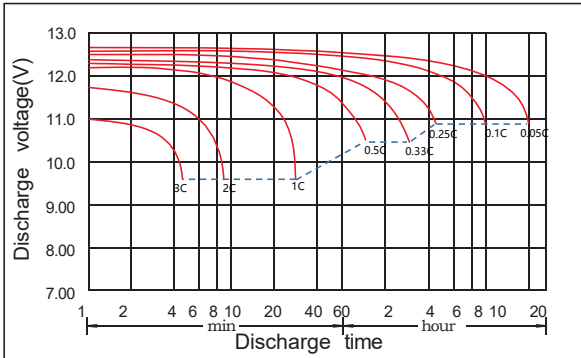

Charging characteristic

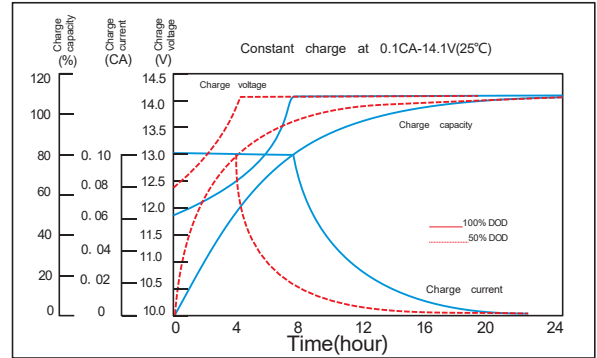

The effect of temperature on capacity

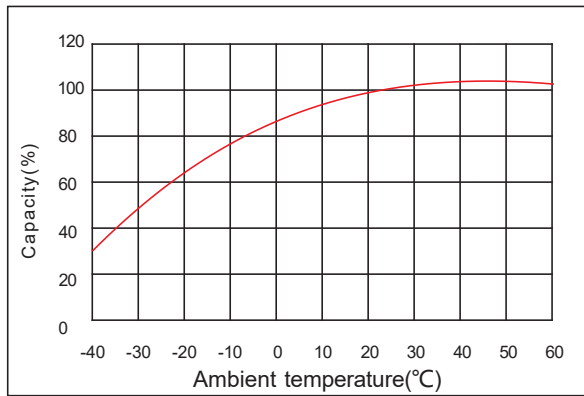

The effect of discharge depth on cycle life

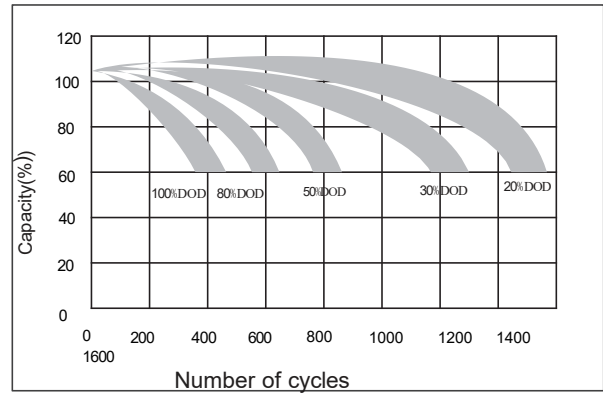

Constant Current Discharge Characteristics Unit:A (25°C,77°F)

FV/Time	5min	10min	15min	30min	45min	1h	1.5h	2h	3h	4h	5h	6h	8h	10h	20h
1.60V	97.0	76.0	56.8	31.9	22.0	17.9	14.2	10.6	7.73	6.19	5.26	3.99	3.47	2.77	1.48
1.67V	85.1	67.1	54.6	30.7	21.5	17.5	13.7	10.2	7.50	5.99	5.15	3.95	3.42	2.74	1.46
1.70V	79.4	63.1	53.0	30.2	21.1	17.2	13.5	10.0	7.36	5.68	5.10	3.88	3.36	2.69	1.43
1.75V	71.1	57.2	51.2	29.1	20.6	16.8	13.2	9.72	7.25	5.60	4.87	3.79	3.28	2.63	1.40
1.80V	63.2	51.7	49.6	27.9	20.1	16.4	13.0	9.46	6.86	5.49	4.68	3.72	3.19	2.58	1.34
1.85V	55.7	46.4	46.9	26.9	19.5	15.9	12.5	8.89	6.45	5.16	4.40	3.50	3.00	2.43	1.26

Constant Power Discharge Characteristics Unit: W/cell (25°C ,77°F)

FV/Time	5min	10min	15min	30min	45min	1h	1.5h	2h	3h	4h	5h	6h	8h	10h	20h
1.60V	155	122	104	59.3	40.0	33.3	26.5	19.8	14.6	11.7	9.94	7.88	6.55	5.37	2.94
1.67V	142	112	102	57.6	39.1	32.6	25.8	19.1	14.2	11.3	9.75	7.73	6.45	5.27	2.86
1.70V	135	107	99.1	56.8	38.8	32.3	25.5	18.7	14.0	10.8	9.47	7.67	6.39	5.23	2.84
1.75V	124	100	96.1	55.4	38.5	32.1	25.4	18.3	13.8	10.6	9.29	7.49	6.13	5.11	2.78
1.80V	114	93.0	93.5	53.6	37.9	31.6	25.2	18.2	13.4	10.5	9.05	7.33	5.92	5.00	2.76
1.85V	103	85.8	90.2	52.0	37.2	31.0	24.4	17.1	12.6	9.87	8.51	6.89	5.56	4.70	2.59