



General Features

- ▶ High corrosion resistant performance: Pb-Ca multi-alloy grid
- ▶ Excellent charge acceptance ability
- ▶ Excellent deep cycle discharge capability
- ▶ Strong high and low temperature performance
- ▶ Precision sealing technology
- ▶ Long life



Dimension: 173(L) × 111(W) × 329(H) × 365(TH)

Unit: mm

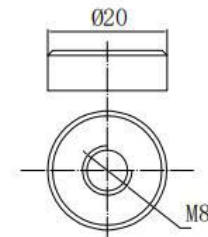
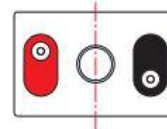
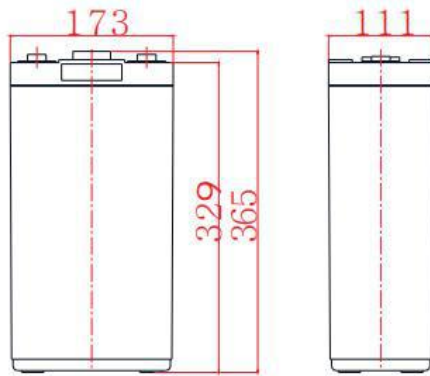

Terminal Dimensions

| Specification | |
|---|---|
| Nominal Voltage | 2V |
| Nominal Capacity | 220Ah |
| Design life | 15 years |
| Terminal | M8 |
| Approx. Weight | Approx 13.0kg (28.7lbs) |
| Container Material | ABS |
| short-circuit current | 2352A |
| Internal resistance(Full charged at 25°C:) | 0.85 mΩ |
| Self discharge | 3% of capacity declined per month at 25°C |
| Operating Temperature | |
| Discharge: | -20 ~50°C(-4~ 122°F) |
| Charge : | -20 ~50°C(-4~ 122°F) |
| Storage: | -20 ~50°C(-4~ 122°F) |
| Charge Method(25 °C) | |
| Charge current: | Max. 44.0A; Recom.22.0A |
| Float charge:2.23-2.27V | recom.2.25V(-3mV/ °C) |
| Equalize charge:2.30-2.35V | recom.2.35V(-4mV/ °C) |
| Cycle charge:2.40-2.50V | recom.2.40V(-5mV/ °C) |

Standards

Executive standard YD/T 799-2010

Applications

- ▶ UPS/EPS
- ▶ Power systems
- ▶ Telecommunications system
- ▶ Auto control system
- ▶ Solar/wind generating storage cyclic
- ▶ Other general purpose

Rated Capacity

| | |
|------------------------------|---------|
| 10Hour Rate (22.0A to 1.80V) | 220.0Ah |
| 3Hour Rate (51.0A to 1.80V) | 153.0Ah |
| 1Hour Rate (112A to 1.75V) | 112.0Ah |

Attain Certificate



Discharge characteristic

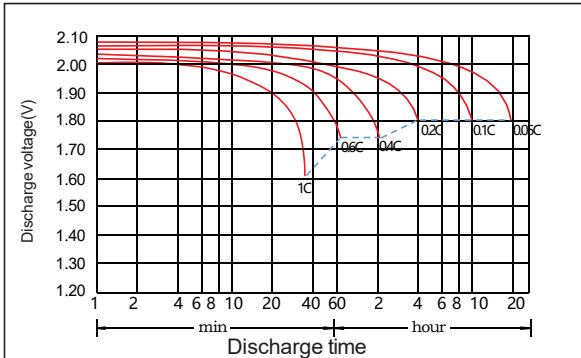

Charging characteristic

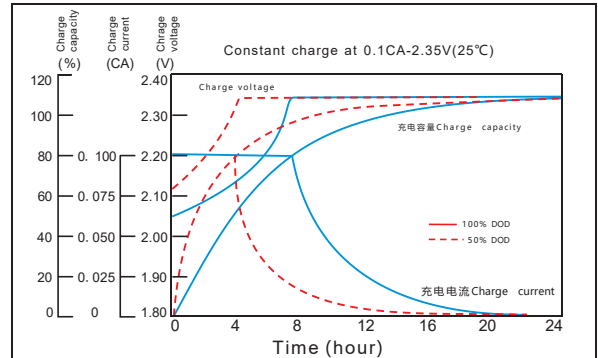

The effect of temperature on capacity

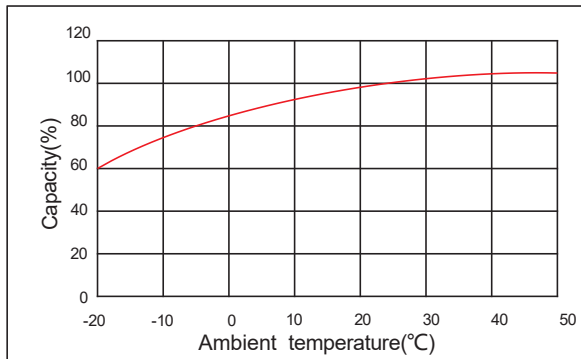

The effect of temperature on float life

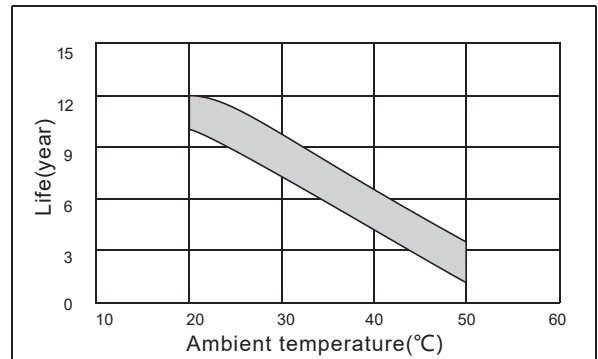

Constant Current Discharge Characteristics Unit:A (25°C,77°F)

| FV/Time | 5min | 10min | 15min | 30min | 45min | 1h | 1.5h | 2h | 3h | 4h | 5h | 6h | 8h | 10h | 20h |
|---------|------|-------|-------|-------|-------|------|------|------|------|------|------|------|------|------|------|
| 1.60V | 360 | 306 | 255 | 167 | 142 | 118 | 90.4 | 80.2 | 57.4 | 43.1 | 39.6 | 31.9 | 26.9 | 23.8 | 11.4 |
| 1.65V | 330 | 284 | 238 | 156 | 136 | 116 | 89.1 | 78.2 | 55.9 | 42.7 | 38.6 | 31.6 | 26.5 | 23.6 | 11.2 |
| 1.70V | 307 | 262 | 220 | 147 | 130 | 114 | 87.7 | 75.5 | 54.3 | 42.0 | 38.3 | 31.1 | 26.0 | 23.2 | 11.1 |
| 1.75V | 274 | 236 | 202 | 137 | 124 | 112 | 86.4 | 72.8 | 52.6 | 41.3 | 37.2 | 30.6 | 25.8 | 22.9 | 10.9 |
| 1.80V | 235 | 209 | 188 | 128 | 119 | 109 | 83.6 | 68.7 | 51.0 | 39.8 | 36.3 | 29.4 | 25.2 | 22.0 | 10.5 |
| 1.85V | 206 | 183 | 165 | 114 | 106 | 98.6 | 82.3 | 64.1 | 48.4 | 39.4 | 35.1 | 29.1 | 24.5 | 21.8 | 10.2 |

Constant Power Discharge Characteristics Unit: W/cell (25°C ,77°F)

| FV/Time | 5min | 10min | 15min | 30min | 45min | 1h | 1.5h | 2h | 3h | 4h | 5h | 6h | 8h | 10h | 20h |
|---------|------|-------|-------|-------|-------|-----|------|-----|------|------|------|------|------|------|------|
| 1.60V | 605 | 518 | 449 | 305 | 262 | 221 | 170 | 150 | 108 | 82.3 | 75.5 | 60.9 | 51.5 | 46.3 | 22.2 |
| 1.65V | 553 | 479 | 424 | 286 | 252 | 218 | 167 | 147 | 105 | 80.9 | 74.1 | 60.2 | 50.8 | 45.8 | 22.0 |
| 1.70V | 529 | 443 | 396 | 269 | 241 | 213 | 165 | 142 | 102 | 79.6 | 72.8 | 59.4 | 50.0 | 45.2 | 21.7 |
| 1.75V | 477 | 401 | 369 | 250 | 231 | 211 | 162 | 137 | 99.3 | 78.2 | 70.7 | 58.5 | 49.5 | 44.4 | 21.4 |
| 1.80V | 422 | 361 | 348 | 235 | 220 | 206 | 157 | 129 | 95.9 | 76.2 | 68.7 | 56.2 | 48.4 | 42.8 | 20.7 |
| 1.85V | 369 | 320 | 309 | 211 | 199 | 187 | 155 | 120 | 91.1 | 74.1 | 66.6 | 55.6 | 47.1 | 42.5 | 20.5 |