

## OPZV2-420



### General Features

- › Nanosilica colloidal electrolyte and tubular plate design to enhance battery performance
- › Tubular plate design makes long battery life
- › Relatively rich electrolyte, high temperature and low temperature performance is superior
- › Long cycle life, excellent deep cycle discharge ability
- › Excellent charge acceptance ability
- › Precision sealing technology



Dimension: 145(L)×206(W)×473(H)×505(TH) Unit: mm

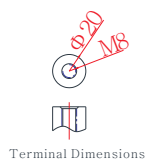
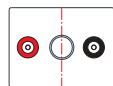
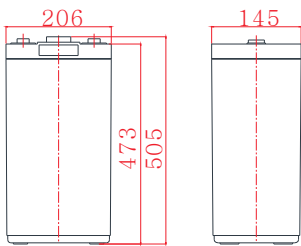

Terminal Dimensions

### Applications

- › Solar / wind energy and other new energy storage
- › Power systems
- › Telecommunications system
- › UPS/EPS
- › Auto control system
- › Other general purpose

### Specification

Nominal Voltage	2V	
Nominal Capacity	420Ah	
Design life	20 years	
Terminal	M8	
Approx. Weight	Approx 33.5kg (73.9lbs)	
Container Material	ABS	
Rated Capacity	420Ah	10Hour Rate (42.0A to 1.80V)
	315Ah	3Hour Rate (105A to 1.80V)
	210Ah	1Hour Rate (210A to 1.80V)
Internal resistance	Full charged at 25°C: 0.55 mΩ	
Max. Discharge Current	2100A(5S)	
Operating Temperature	Discharge: -15~50°C(5~ 122°F)	
	Charge: -15~50°C(5~ 122°F)	
	Storage: -20 ~40°C(-4~ 104°F)	
Charge current:	Max.85A ; Recom.42A	
Charge Method (25 °C)	Float Charge:2.23-2.25V,recom.2.25V(-3mV/ °C)	
	Equalize charge:2.30-2.40V,recom.2.35V(-4mV/ °C)	
	Cycle charge:2.35-2.45V,recom.2.40V(-5mV/ °C)	
Self discharge	3% of capacity declined per month at 25°C	

### Constant Current Discharge Characteristics Unit: A (25°C, 77°F)

F.V/Time	15min	30min	1h	2h	3h	4h	5h	6h	8h	10h
1.60V	426	332	242	156	112	89	75.8	66.6	53.8	44.1
1.65V	411	326	235	152	110	87	75.0	65.9	53.4	43.8
1.70V	388	311	231	147	108	86	74.0	64.8	52.8	43.6
1.75V	363	294	215	143	106	85	72.7	63.5	51.7	43.0
1.80V	338	276	210	139	105	83	71.5	62.0	50.4	42.0
1.85V	311	251	193	131	100	81	68.8	59.8	49.0	41.1

### Constant Power Discharge Characteristics Unit: W/cell(25°C, 77°F)

F.V/Time	15min	30min	1h	2h	3h	4h	5h	6h	8h	10h
1.60V	717	574	434	277	202	161	137	121	98.0	80.4
1.65V	685	545	408	271	199	158	136	120	97.4	80.2
1.70V	647	523	402	265	196	157	134	118	96.6	80.0
1.75V	612	501	384	259	193	155	133	116	95.0	79.2
1.80V	578	481	368	253	190	152	130	114	92.9	77.0
1.85V	537	444	350	240	184	149	127	111	91.1	76.6

# OPZV2-420

### Discharge Characteristics Curve

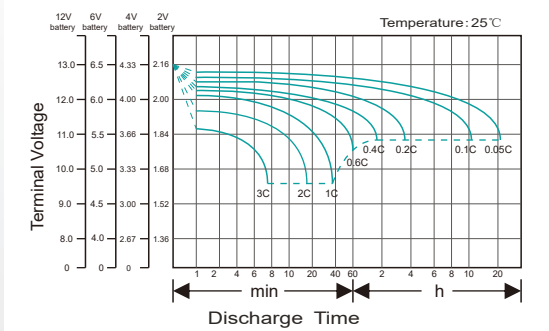

### Charging Characteristics Curve

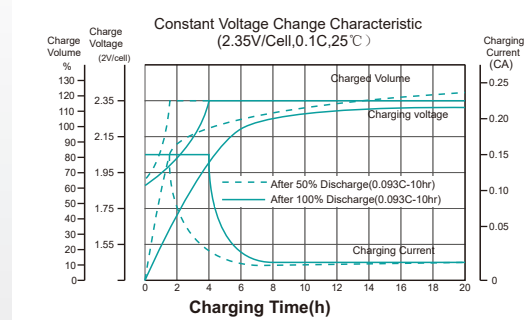

### Cycle life of Different DOD

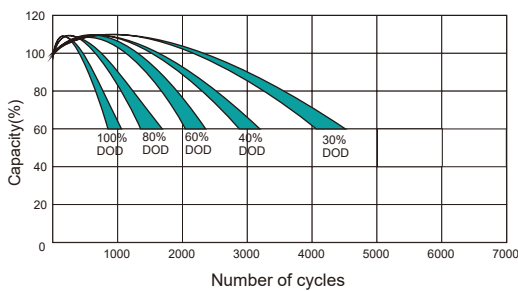

### Float charging service life Curve

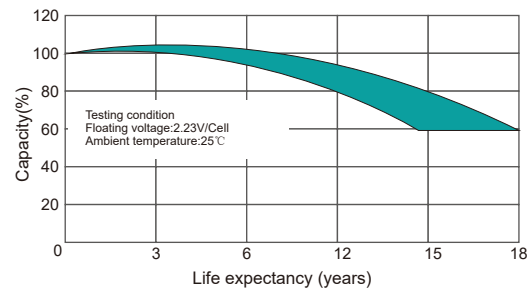

### Charging voltage and temperature relationship

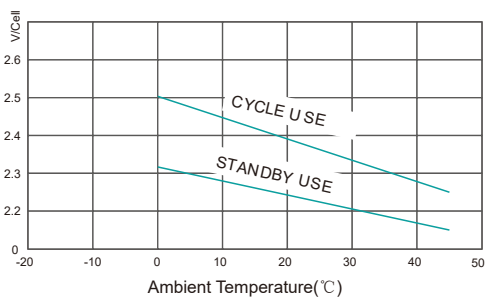

### Self-discharge Characteristics

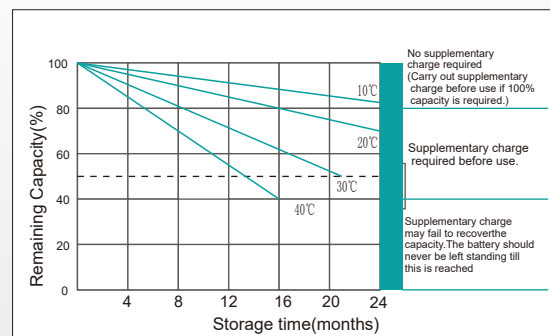

[www.kiju.com.cn](http://www.kiju.com.cn)    [info@kiju.com.cn](mailto:info@kiju.com.cn)

+86-791-85982779    +86-791-85989842

**Jiangxi Jingjiu Power Science&Technology Co. Ltd.**  
Add: 1388 Fushan No.1 Street, Xiaolan Economic Development Zone, Nanchang City, Jiangxi Province, China.

**Jiangxi Jingjiu Power ( Jiujiang) Co. Ltd.**  
Add: Xiwang Rd, Aicheng Industrial Park, Yongxiu Country, Jiujiang City, Jiangxi Province, China.

